

Key Features

The Receiver (model VR/R2E) is designed for use with the TS 970, TS 971 and TS 981 automatic door control panels.

The Receiver can store up to 85 transmitter codes. Programming is done in self-learning mode with one button.

The transmitter code changes on every activation to prevent scanning or copying of the signal.

A special algorithm keeps the transmitter and receiver synchronized. (Keeloq® Hopping code)

Only transmitters whose codes are held in the receiver memory will activate the receiver.

Technical Specification

Receiver type		Super heterodyne
Carrier frequency		433.92 MHz
Local oscillator frequency		6.6128 MHz
Demodulation		AM/ASK
Local Oscillator		VCO / PLL
Channel width		>25 KHz
Intermediate frequency		10.7 MHz
Input sensitivity		-115 dBm
Local oscillator spurious emissions		< -57 dBm
Input load		50 Ohm
Power supply		12 / 24 Vac/dc
Consumption	Steady / 12 Vdc (2 relays excited)	13 mA / 18 mA
	Steady / 24 Vdc (2 relays excited)	24 mA / 41 mA
Max applicable power		24VA
Relay numbers		2
Contacts		NO, NO/NC
Memory capacity		85 user codes
TX security code		Rolling code
Maximum code combination number		2 ⁶⁴
Operating temperature		-20°/+70°C
Housing protection		IP65
Weight		gr. 130
Overall dimensions (mm)		80 x 80 x 50
Complies with European Directives		89/336/EEC
		73/23/EEC
and Regulation		EN 60950

40019028 00001

VR/R2E

Radio Receiver

2 Channel

433.92 MHz

Rolling Code



INSTRUCTIONS

Installation

For best operation / reception the receiver must not be mounted close to sources of interference such as apparatus producing strong magnetic fields, information systems or any equipment producing radio emissions.

Remove the receiver cover and fix the box using the screws and plugs supplied. Fit the caps supplied to the screw heads.

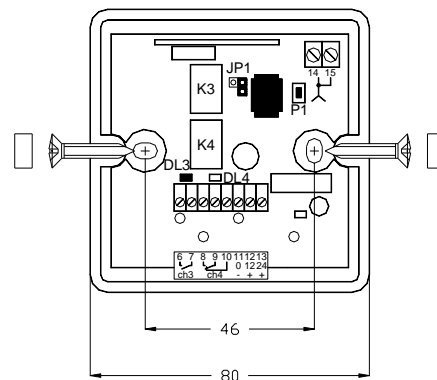

Electrical Connections

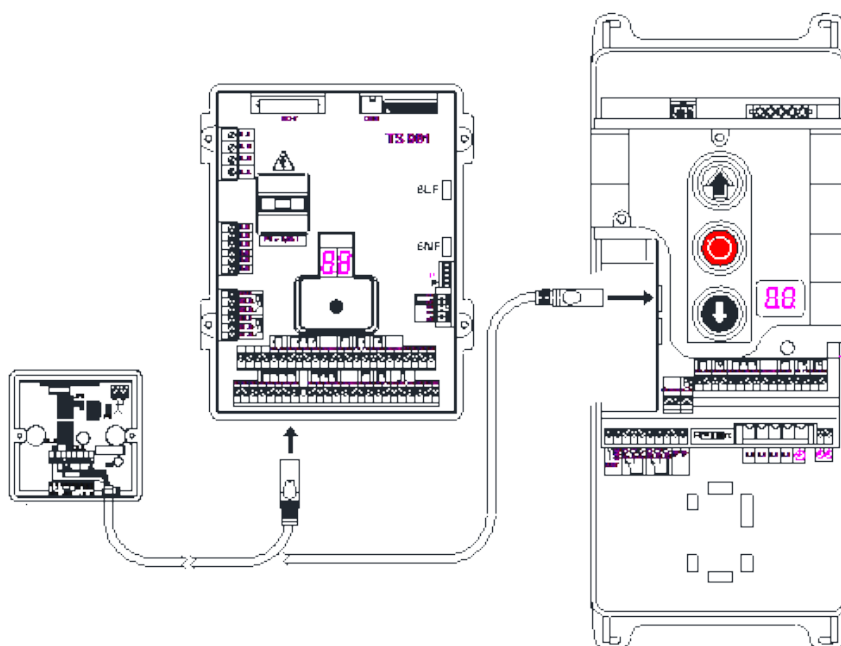

Connecting to the TS 970, TS 971 or TS 981 Automatic Door Control Panel

Aerial Connection

A 180mm solid wire aerial is supplied with the radio receiver. Connect the aerial to terminal 14. This aerial is suitable for the majority of installations. For increased range a tuned aerial is available, consult your supplier.

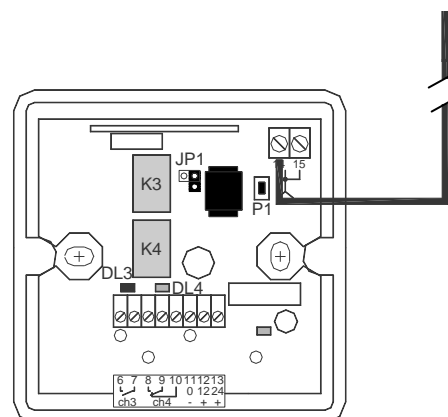

Storing the Transmitter Code into the Receiver Memory

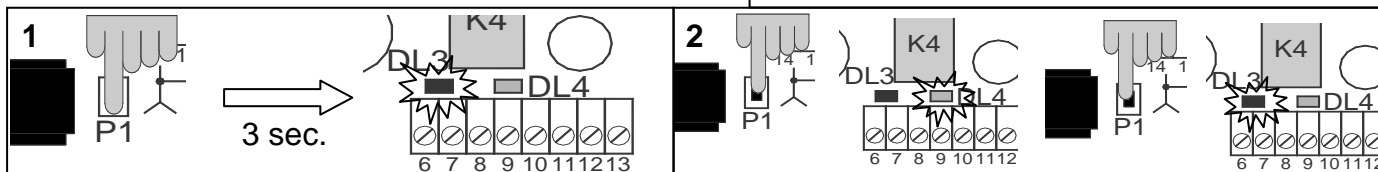
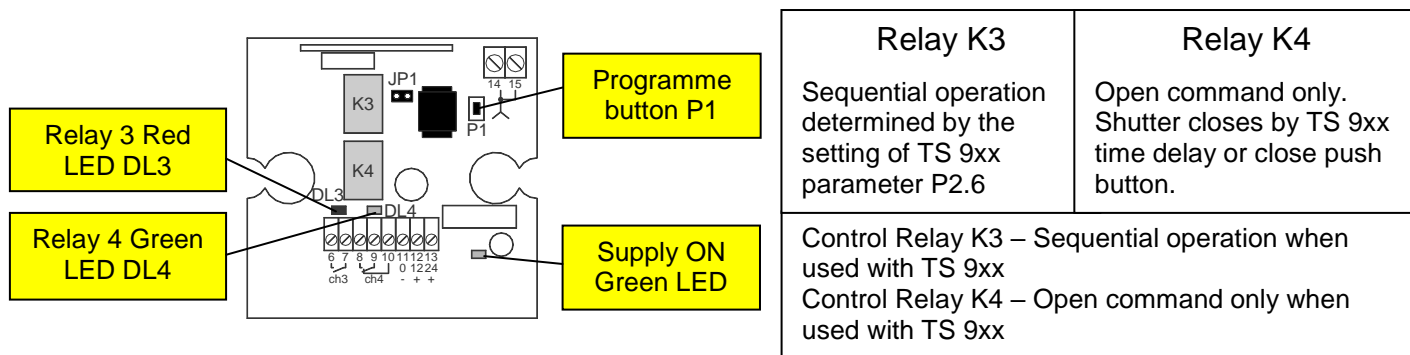

1 Press and hold Radio Receiver button P1 for 3 seconds until red LED DL3 turns on.

2 Press button P1 again to select Relay K3 or K4 indicated by LED DL3 or DL4

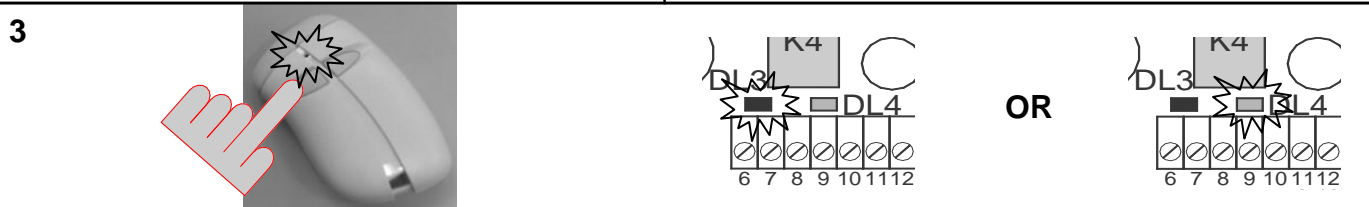

3 Decide which transmitter button will operate the shutter and press it. The selected relay will energise and the corresponding LED will flash. Another transmitter can be added while LED DL3 or DL4 is on.

Relay K4 can be configured as a standard relay, pulse, or a latching relay, step mode. For use with the TS 970, TS 971 and TS981 Automatic Door Controls K4 must be configured as a standard relay.

LINK JP1 Open

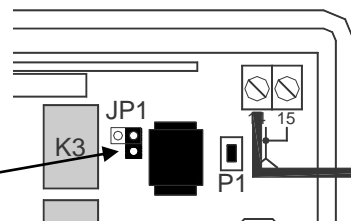

The radio receiver memory will hold 85 transmitter codes. When the memory is full LED DL3 and DL4 will flash 3 times and the operation fails if an attempt is made to store another transmitter code.

Cancelling Transmitter Codes from the 2-Channel Mini

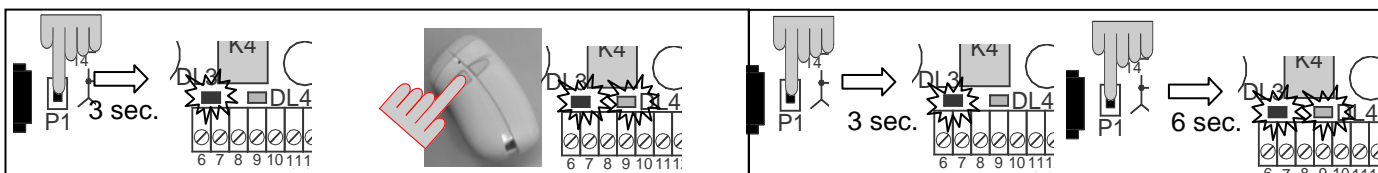

Cancelling a Single Transmitter Code.
Press and hold Radio Receiver button P1 for 3 seconds until red LED DL3 turns on. Press the Transmitter button that is to be cancelled. If it is a stored code it will be cancelled and LED's DL3 and DL4 will flash twice.

Cancelling all Transmitter Codes.
Press and hold Radio Receiver button P1 for 3 seconds until red LED DL3 turns on. Release and Press P1 again, hold for 6 seconds until LED's DL3 and DL4 flash three times.



Battery Replacement



Replace the battery with type 23A – L1028 only.

Remove the battery cover.



Remove the old battery and replace

Ensure that the new battery is correctly oriented (+ / -)

Declaration of Conformity

Hereby, CDVI Wireless Spa, declares that the radio equipment type VR/TFxE is in compliance with directive 2014/53/EU. The full text of the EU declaration of conformity is available at the following internet address: www.gfa-elektromaten.co.uk

Supplied by:

GfA ELEKTROMATEN UK Ltd

Agincourt road, Warwick CV34 6XZ, England.
Telephone: 01926 452452 Fax: 01926 336417
E-mail: sales@gfa-elektromaten.co.uk
Web Site: www.gfa-elektromaten.co.uk

Manufactured by: CDVI Wireless Spa

Via Piave, 23 - 31020
San Pietro di Feletto (TV) - Italy

