

Mechanical accessories

17.1 Stub shafts

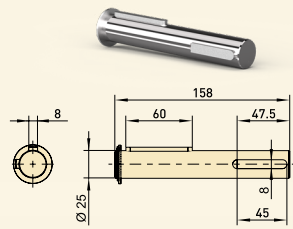

25 Part no.
30002596

for series

SG50

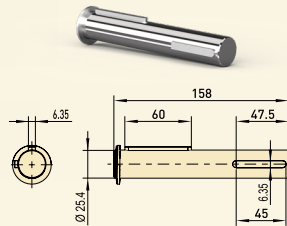

25.4 Part no.
30002628

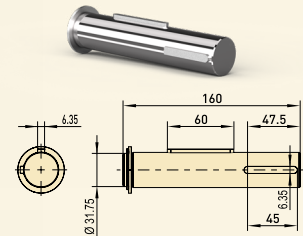

31.75 Part no.
30002699

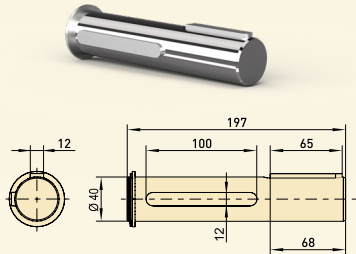

40 Part no.
30002637

for series

SG85



for series

SG115

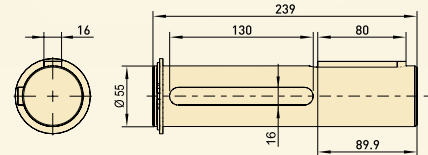
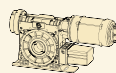

55 Part no.
30003078

17.2 Adapter shafts

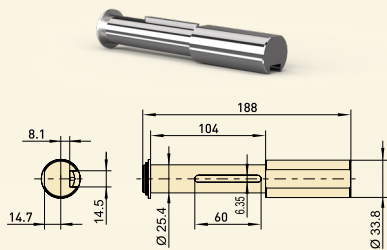

25.4/33.8 Part no.
30004619

for series

SG50

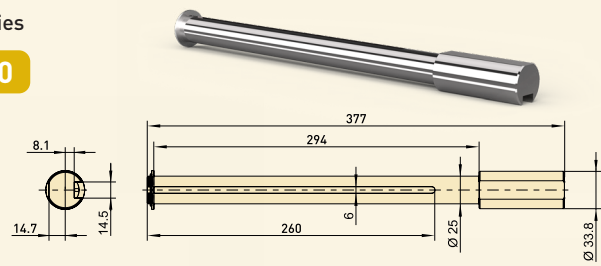

25.4/33.8 Part no.
30004710

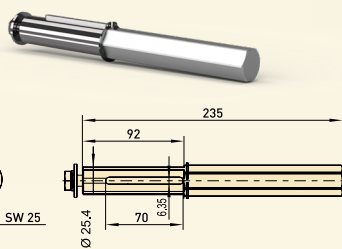

25.4/SW25 Part no.
30004823

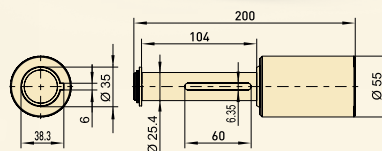

25.4/35 Part no.
30004630

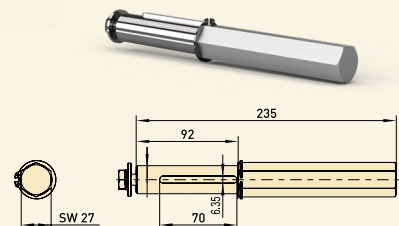

25.4/SW27 Part no.
30002125

Mechanical accessories

17.3 Adapter stub shafts

for series

SG50

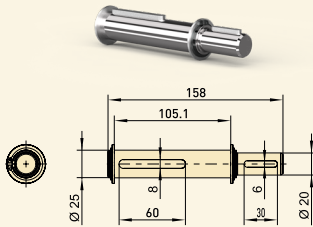

25/20 Part no.
30004845

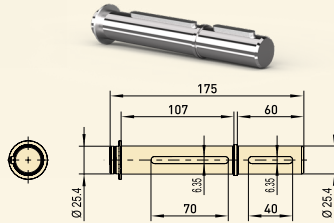

25.4/25.4 Part no.
30002691

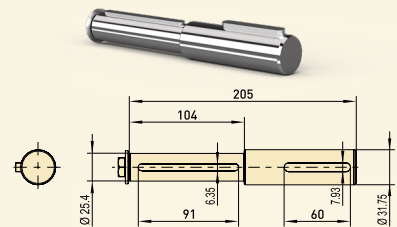

25.4/31.75 Part no.
30005146

for series

SG85

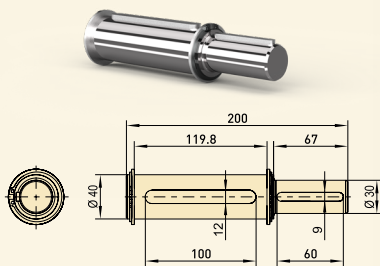

40/30 Part no.
30004436

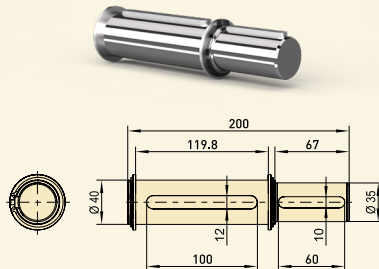

40/35 Part no.
30003288

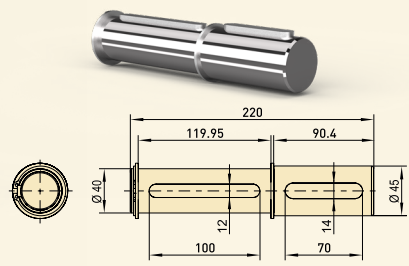

40/45 Part no.
30005125

for series

SG115

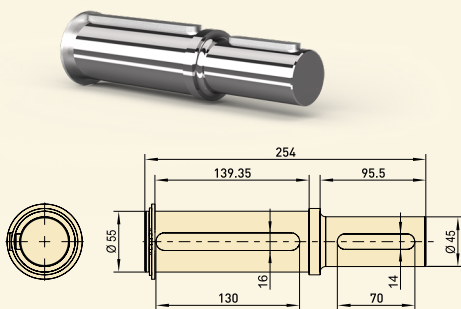
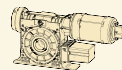

55/45 Part no.
30003305

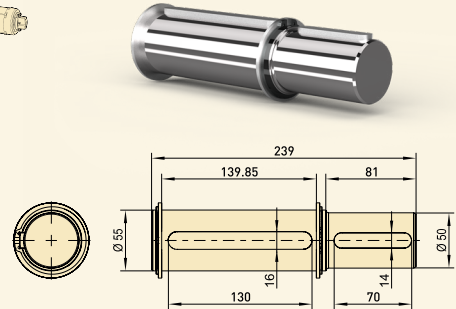

55/50 Part no.
30004879